

卫生级视镜

SANITARY SIGHT GLASS

直通焊接式视镜
Welded straight sight glass

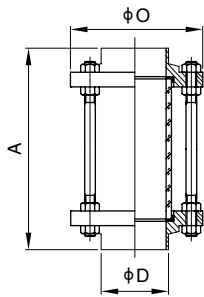

DIN				No.KST-SG001				SMS/ISO/IDF/3A				No.KST-SG002			
Size	A	DV	O	Size	A	D	O	Size	A	D	O	Size	A	D	O
DN25	140.0	28.0	78.0	1"	25	140.0	25.4	78.0	1 1/4"	32	140.0	32.0	78.0		
DN32	140.0	34.0	78.0	1 1/2"	38	140.0	38.1	86.0	2"	51	142.0	50.8	102.0		
DN40	140.0	40.0	86.0	2 1/2"	63	144.0	63.5	115.0	3"	76	144.0	76.2	128.0		
DN50	142.0	52.0	102.0	3 1/2"	89	148.0	89.0	139.0	4"	102	152.0	101.6	154.0		
DN65	144.0	70.0	120.0												
DN80	148.0	85.0	134.0												
DN100	152.0	104.0	154.0												

卡箍式直通视镜
Clamped straight sight glass

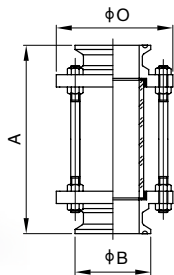

DIN				No.KST-SG003				SMS/ISO/IDF/3A				No.KST-SG004			
Size	A	B	O	Size	A	B	O	Size	A	B	O	Size	A	B	O
DN25	156.0	50.5	78.0	1"	25	156.0	50.5	78.0	1 1/4"	32	156.0	50.5	78.0		
DN32	156.0	50.5	86.0	1 1/2"	38	160.0	50.5	86.0	2"	51	166.0	64.0	102.0		
DN40	164.0	50.5	90.0	2 1/2"	63	168.0	77.5	115.0	3"	76	172.0	91.0	128.0		
DN50	166.0	64.0	106.0	3 1/2"	89	178.0	106.0	139.0	4"	102	194.0	119.0	154.0		
DN65	168.0	91.0	124.0												
DN80	172.0	106.0	139.0												
DN100	192.0	119.0	159.0												

球型视镜
Ball-type sight glass

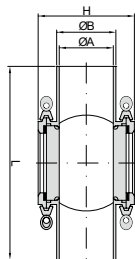

No.KST-SG005				
Size	A	B	H	L
DN25	28	25	67	90
DN32	34	31	78	100
DN40	40	37	83	130
DN50	52	49	99	165
DN65	70	66	125	205
DN80	85	81	145	250
DN100	104	100	168	300

活接式视镜
Union sight glass

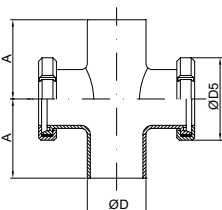

DIN				No.KST-SG006			
DN	A	D	D5	DN	A	D	D5
DN25	35	29	63	DN25	35	29	63
DN32	38	35	70	DN32	38	35	70
DN40	40	41	78	DN40	40	41	78
DN50	42	53	92	DN50	42	53	92
DN65	47	70	110	DN65	47	70	110
DN80	52	85	125	DN80	52	85	125
DN100	62	104	146	DN100	62	104	146