

# 迷你手动隔膜阀 KST205

## MINI MANUAL DIAPHRAGM VALVE

工作压力：0-10bar  
 工作温度：-40~150℃  
 驱动机构：手动控制  
 密封材质：EPDM,EPDM+TFM  
 阀体设计：直通阀体设计  
 阀体材质：316L（铸造，EN1.4409 CF3M）  
 接口尺寸：DN20-DN50  
 接口方式：KST205-1：焊式、KSYT205-2焊卡式、  
 KST205-3:卡式  
 表面处理：外表面Ra≤0.5μm（SF1），  
 内表面Ra≤0.375μm（SF4）  
 接口标准：ISO,DIN,ASME BPE.3A,BS

Working pressure: 0-10bar  
 Working temperature: -40~150℃  
 Drive mechanism: manual control  
 Seal material: EPDM+TFM, EPDM  
 Body design: straight through valve design  
 Body material: 316L (casting, CF3M EN1.4409)  
 Interface size: DN20-DN50  
 Interface type: KST205-1 type, KST205-2 type welding: welding,  
 KST205-3: card  
 Surface treatment: the outer surface of Ra is less than or equal to  
 0.5 m (SF1),  
 The inner surface of Ra is less than or equal to 0.375 m (SF4)  
 Interface standard: ISO, DIN, BPE.3A BS, ASME

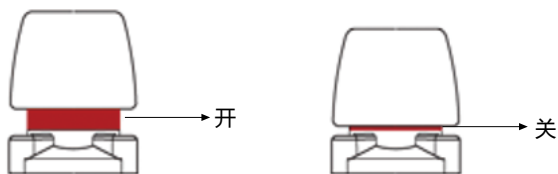

Indicator	DN15
open	7
close	1

### 驱动器

类型：KST-PC205

尺寸：DN20-DN50

主要材质：PC手轮、阀帽、不锈钢阀杆、支座

状态显示：手动开关状态显示如图

Drive

Type: KST-PC220

Size: DN20-DN50

Main material: PC hand wheel, valve cap, stainless steel valve stem, bearing

Status display: manual switch status display

# 迷你手动隔膜阀

## MINI MANUAL DIAPHRAGM VALVE

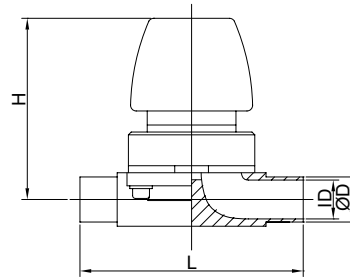

No.KST205-1

Size	ΦD	ΦD1	ID	L	H	J
DN8	12.7	-	9.4	72	55	35
DN10	12.7	-	9.4	72	55	35

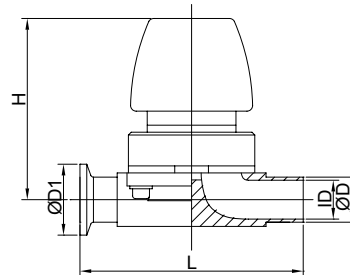

No.KST205-2

Size	ΦD	ΦD1	ID	L	H	J
DN8	12.7	25.4	9.4	80.5	55	35
DN10	12.7	25.4	9.4	80.5	55	35

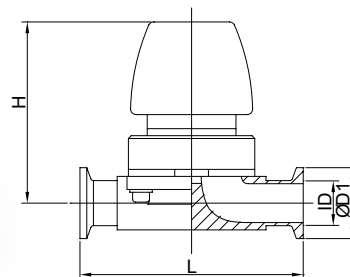

No.KST205-3

Size	ΦD	ΦD1	ID	L	H	J
DN8	-	25.4	9.4	89	55	35
DN10	-	25.4	9.4	89	55	35